

RE60 GRIP GRAB POT MAGNETS

Rare earth pot magnets are extremely useful for holding, actuating, pushing, pulling, hanging, locating, separating, retrieving...the list never ends!

A Series - Countersunk Centre Hole

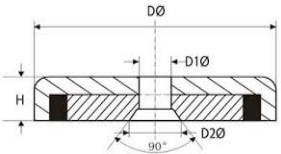

"A" Series	D (mm)	D1 (mm)	D2 (mm)	H (mm)	Attraction (kg)	Dead Weight (g)
A16	16	3.5	6.5	5	5	7
A20	20	4.5	8.5	7	6	13
A25	25	5.5	10.4	8	14	23
A32	32	5.5	10.4	8	25	39
A36	36	6.5	12	9	29	52
A42	42	6.5	12	9	37	76
A48	48	8.5	16	11.5	68	120
A60	60	8.5	16	15	112	252
A75	75	10.5	19	18	162	488

B Series - Straight Hole

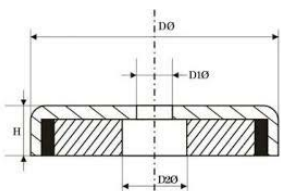

"B" Series	D (mm)	D1 (mm)	D2 (mm)	H (mm)	Attraction (kg)	Dead Weight (g)
B16	16	3.5	6.5	5	4	6
B20	20	4.5	8	7	6	12
B25	25	5.5	9	8	14	23
B32	32	5.5	9	8	23	36
B36	36	6.5	11	9	29	50
B42	42	6.5	11	9	32	73
B48	48	8.5	15	11.5	63	114
B60	60	8.5	15	15	95	240
B75	75	10.5	18	18	155	471
B88	88	12.5	20	20	180	480

C Series - Male Thread

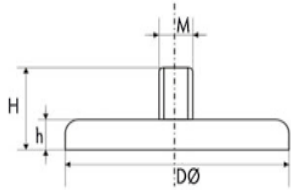

"C" Series	D (mm)	M (mm)	H (mm)	h (mm)	Attraction (kg)	Dead Weight (g)
C10	10	3	12	5	2.2	3.5
C16	16	4	13	5	5.5	7.5
C20	20	4	15	7	9	16
C25	25	5	17	8	22	30
C32	32	6	18	8	34	45
C36	36	6	18	8	41	57
C42	42	6 OR 8	20	9	68	84
C48	48	8	24	11.5	81	130
C60	60	8	30	15	113	254
C75	75	10	34	15	164	550

D Series - Female Threaded Boss

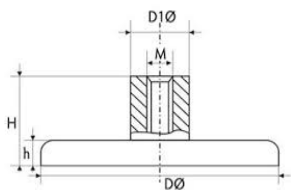

"D" Series	D (mm)	M (mm)	D1 (mm)	H (mm)	Attraction (kg)	Dead Weight (g)
D10	10	3	12	5	2.2	3.5
D16	16	4	13	5	5.5	8
D20	20	4	15	7	9	17
D25	25	5	17	8	22	32
D32	32	6	18	8	34	47
D36	36	6	18	8	41	59
D42	42	6	20	9	68	87
D48	48	8	24	11.5	81	132
D60	60	8	30	15	113	270
D75	75	10	34	18	164	552

E Series - Complete with Hook

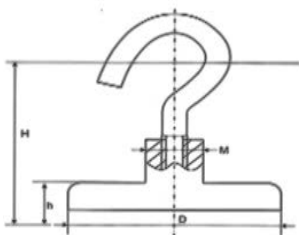

"E" Series	D (mm)	M (mm)	H (mm)	h (mm)	Attraction (kg)	Dead Weight (g)
E16	16	4	14	5	5.5	11
E20	20	4	14	7	9	21
E25	25	5	15	8	22	37
E32	32	6	16	8	34	56
E36	36	6	16	8	41	68
E42	42	6	16	9	68	97
E48	48	8	23	11.5	81	154
E60	60	8	23	15	113	282
E75	75	10	25	18	164	560

Head Office: 16 Prince of Wales Ave, Unanderra NSW 2526

T +61 2 4272 8180 F +61 2 4272 5927 sales@magnetsalesaust.com.au

www.magnetsalesaust.com.au

ABN 59 171 188 983